

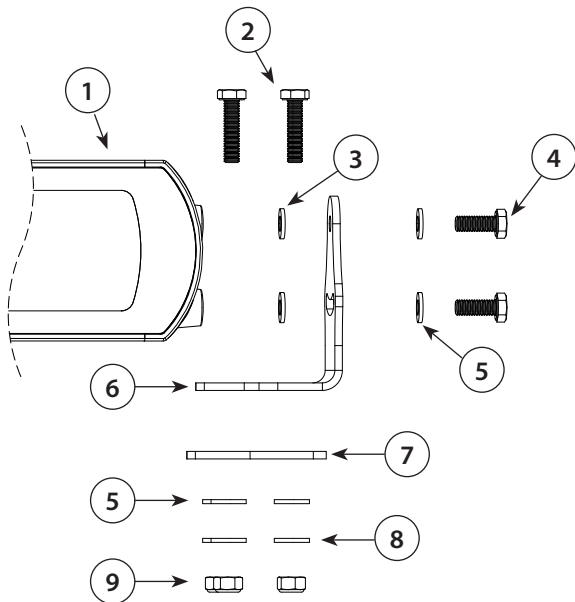

Please read the following pages before attempting installation to ensure complete understanding of Lumishore Spotlight - Curved. This product should only be installed, inspected, and maintained by a qualified electrician only, in accordance with all applicable electrical codes. Be certain electrical power is OFF before and during installation and maintenance.

**What's Included**



Item		Qty
(1)	Spotlight - Curved	(1)
(2)	M6 x 25mm Hex Bolt	(6)
(3)	M6 Nylon Washer	(4)
(4)	M6 x 16mm Hex Bolt	(4)
(5)	M6 Flat Washer	(10)
(6)	Bracket	(2)
(7)	Flat Plate	(2)
(8)	M6 Spring Washer	(6)
(9)	M6 Nylon Insert Nut	(6)

**Basic Dimensions**

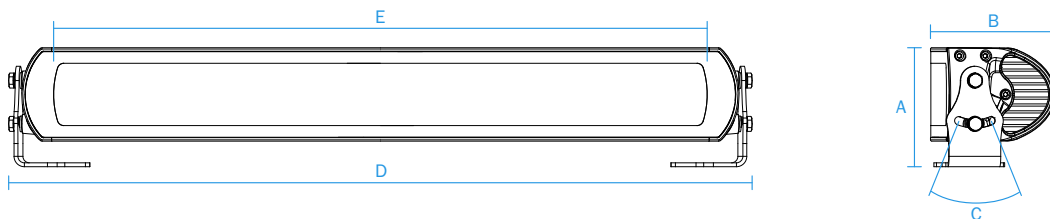

Model of Light	A	B	C	D	E
20"	92mm	96mm	44°	573mm	498mm
30"	92mm	111mm	44°	823mm	749mm
40"	92mm	132mm	44°	1070mm	999mm
50"	92mm	158mm	44°	1315mm	1246mm

FOR REFERENCE ONLY

### Installation Instructions:

1. Select mounting location. Mounting location should be flat and durable.
2. Using a suitable bit, drill the bracket holes. Brackets have a 6.5mm hole suitable for M6 bolts (supplied).
3. Drill an 8.5mm (0.334in) hole for the cable. The cable should always be in a 'fixed' position, no movement or rotation. The cable entry should be made watertight, the use of a cable gland is recommended.
4. Fix brackets in place using supplied M6 bolts, flat plate, washers and nylon insert nuts. Apply the appropriate torque based on fixings used and mounting surface.
5. Mount the flood light to brackets using the supplied M6 bolt, spring and nylon washers. Ensure nylon washers are placed on the inside of the stainless steel bracket. Tighten to a torque of 5Nm, DO NOT overtighten.

### Wiring Diagrams:

Wiring should be carried out as per ABYC guidelines. The Lumishore Spotlight - Curved will operate with a simple On/Off switch, it can also be controlled by MFD via LUX Light Control Module and Lumi-Link Command Center. For further electrical installation instructions and wiring diagrams please refer to the LUX Light Module installation guide (45-0145). Each lighting circuit must be fused accordingly.

Model of Light	Voltage	Amps (max)
20"	10-31VDC	12.8A
30"		19.3A
40"		25.7A
50"		32.1A

### Single switch wiring - Control via latching switch

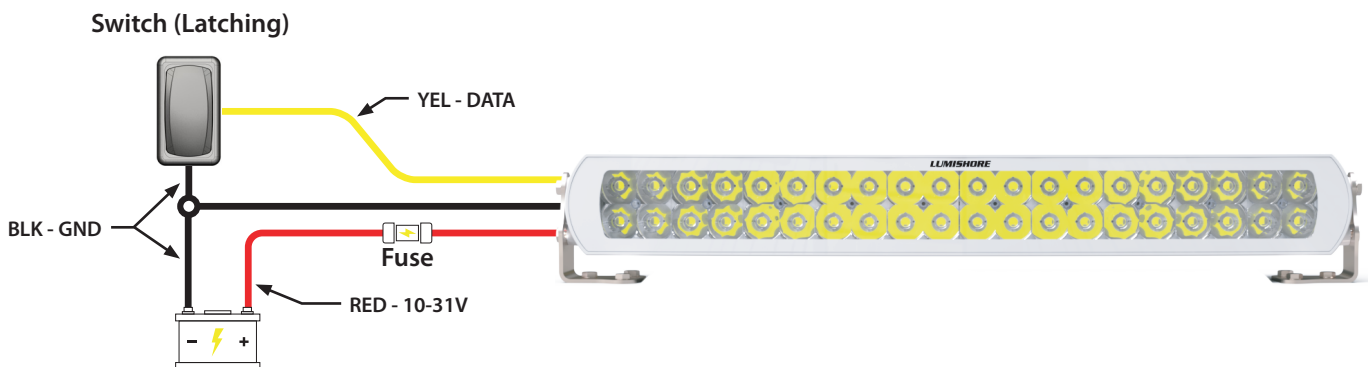

### Light Operation (Latching switch):

1. Turn switch ON to power light at full power.
2. Toggle switch once to begin dimming cycle.
3. Toggle switch again to pause dimming cycle.
4. Turn switch OFF for 5 seconds to restart at full power

**Max 16 lights per LUX Light Module**

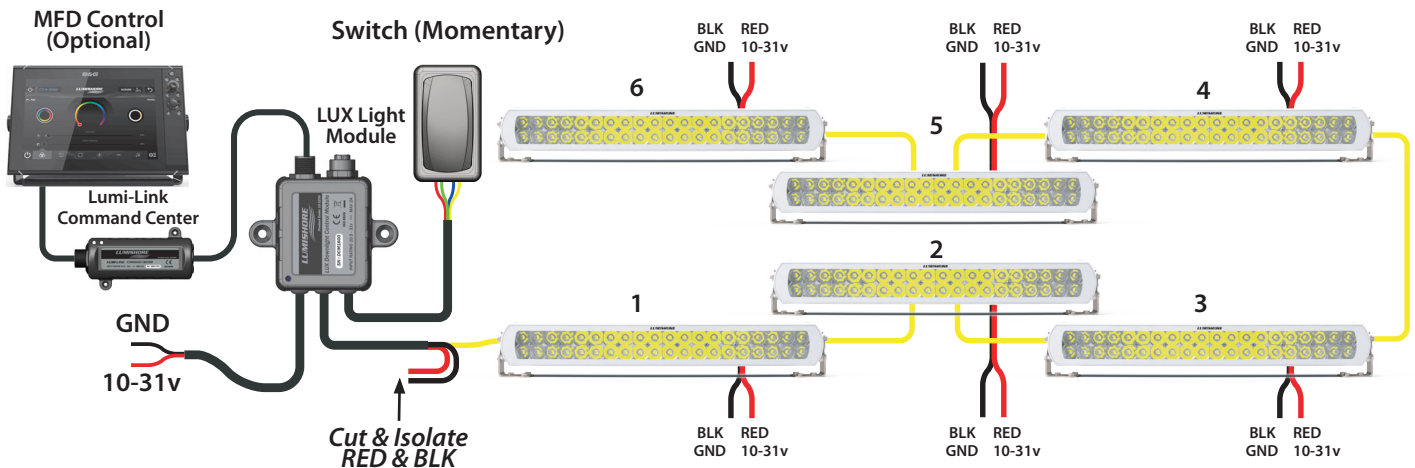

**Note :** Black wire from each light and LUX Module should connect to common ground

**Light Operation (Momentary switch):**

1. Press switch once to turn ON.
2. Press and hold to dim lights.
3. Press switch once to turn OFF.

**Cleaning and Maintenance:**

Use only soap and water to clean the light using a soft cloth. DO NOT use any chemical cleaners and DO NOT power wash. Inspection of the light should be carried out regularly.

**Warranty:**

LUMISHORE Ltd warrants the **Spotlight - Curved** to be free from defects in workmanship and materials for a period of **two** years, starting from the date of original purchase. Misuse, abuse, improper installation, neglect, improper shipping, damage caused by disasters such as fire, flood, and lightning, installation by unqualified personnel, unauthorized repair or modification will void this warranty. For the avoidance of confusion and doubt, non-compliance with all installation, maintenance and operating instructions in this document constitute non-conformance with warranty terms.

***LUMISHORE***

